

SUITE **3520** RSF **1,831 SF**

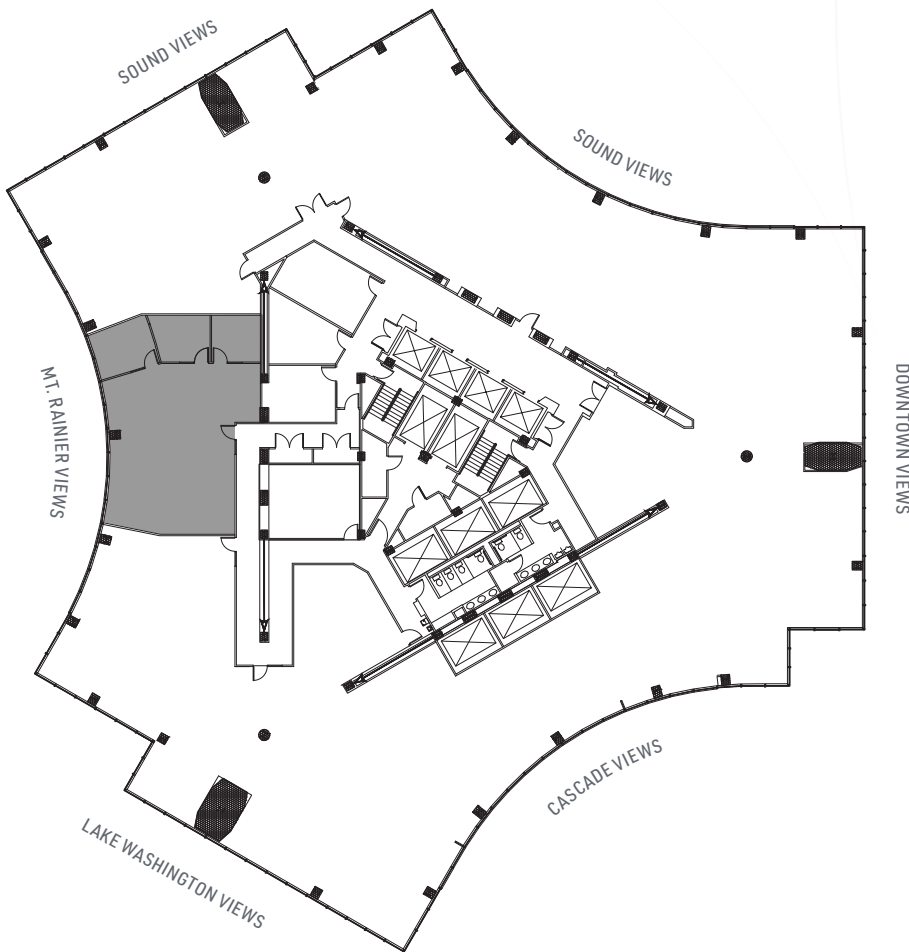

Expansive windows offer panoramic views of Seattle, Puget Sound, and the surrounding mountains



Over 24 on-site dining options with additional services like dry cleaning, shoeshine, optometrist, printing, and more

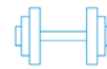

A full-service fitness center with classes, massage service, showers and lockers on Floor 2



The newly renovated Sky Lobby on Floor 40 will feature a Private Tenant Lounge for less formal meetings



For two-wheeled commuters, we offer secured bicycle storage and men and women's shower facilities



Over 700 spaces in the underground parking garage, including Zip Cars, and EV charging stations



A newly-renovated Conference Center on Floor 40 will provide tenants with a stunning space to host meetings when a little extra space is needed



SONET fiber service provides full redundancy to minimize network downtime in the case of an outage.

For more information:

**JOHN HANSEN**  
+1 206 386 5385  
john.hansen2@cbre.com

**JJ SHEPHARD**  
+1 206 292 6031  
jj.shephard@cbre.com

**CHELSIE BARRETT**  
+1 206 386 5364  
chelsie.barrett@cbre.com

CBRE, Inc.  
1420 5th Avenue, Suite 1700  
Seattle, WA 98101

